

X44

Gearbox for 12M26.2

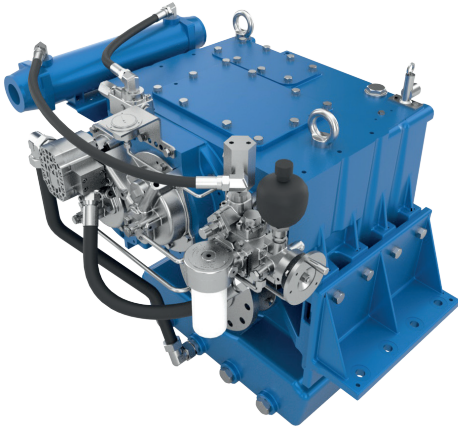

X44			
Power/RPM kW/RPM (hp/RPM)	Maximum rated input kW (hp)	Ratio	Maximum input RPM
0,540 (0,724)	1134 (1521)	3,026*	2100
		3,486*	
		4,032*	
		4,448*	
		5,077	
		5,542*	
5,913			
Dry Weight kg(lb)	1270 (2800)		
SAE bell	#0		
Type	Vertical offset		
Kinematics	Reversible, Engine Wise and Counter Engine Wise		

* Non standard ratio

Sample Powers (kw/hp)

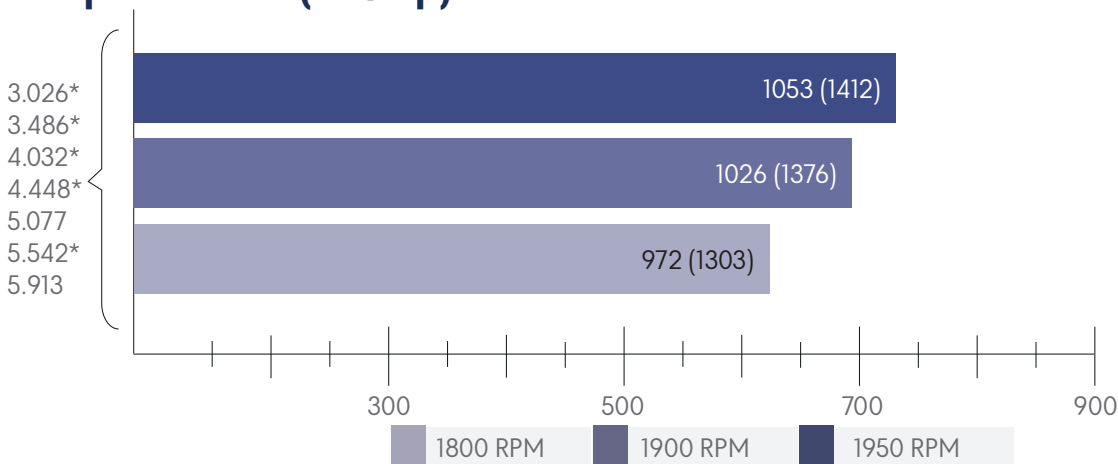

Description

Robust design and easy onboard maintenance. Robust design also withstands continuous duty in workboat, dredger applications

Fully works tested, reliable and simple to install

Reverse reduction marine transmission with hydraulically actuated multi-disc clutches

Case hardened and precisely ground gear teeth for long life and smooth running

Robust cast iron casing for direct or remote mounting

Emergency "get home" capability

Suitable for twin installation with 100% rated power in ahead and astern condition

Standard Equipment

Oil cooler complete with fittings and flexible hoses

Flange coupling

Lube oil pump

Propeller shaft flange and coupling bolt set

Classification by all major Classification Societies on request

Elastic coupling with fail safe device SAE18"

Rigid mounting brackets

Electric clutch control

Set Control Monitoring:
Manometer and Thermometer gauges
Clutch oil pressure sensor monitored by the control system
Low clutch pressure alarm switch monitored by the engine BMS

Options

Live PTO Type: 0 Ratio:0,79/1 / flange SAE B

Clutchable PTO Type: 1 for the one output /Electrical valve control 24V / Ratio: 0.655/1 - 0.800/1 - 0.945/1

Clutchable PTO Type: 2 for two outputs / Electrical valve control 24V / Ratio: 0.658/1 - 0.800/1 - 0.975/1

Hydraulic pump adaptation flange and coupling, not machined for type 182 (to be machined by the customer)

Dimensions and dry weight (mm/kg)

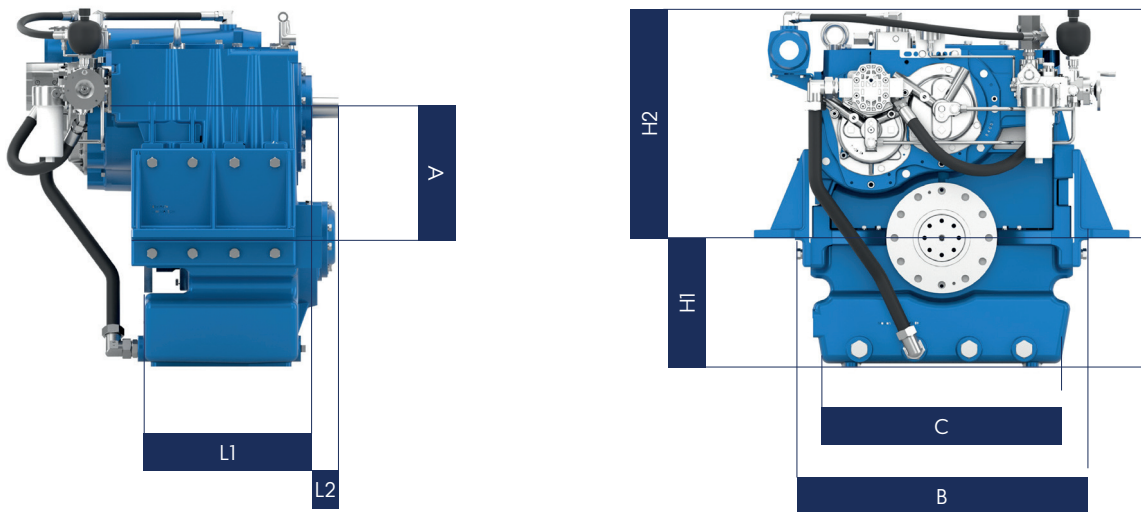

Model	Bell housing	A	B	C	H1	H2	H3	L1	L2	L3	Dry Weight kg(lb)
W4400	#0	400	908	800	400	705	0	524	77	637	1270 (2800)

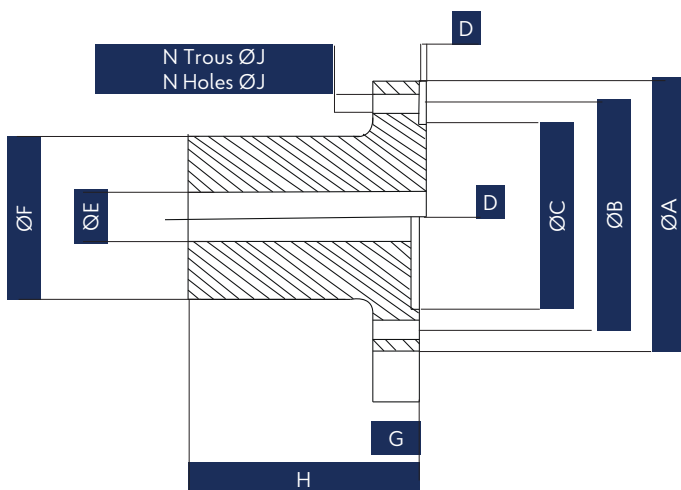

Flange Coupling Dimension												
Type	ØA	ØB +0.15 /-0.15	ØC	D	ØE	ØF	G	H	J	N	Ømaxi forage Ømaxi drilling	CENTRAGE CENTERING
X44	343	292.1	177.8	8	50	240	40	270	24.5	12	150	Female

