

# X52

Gearbox for 12M33.2

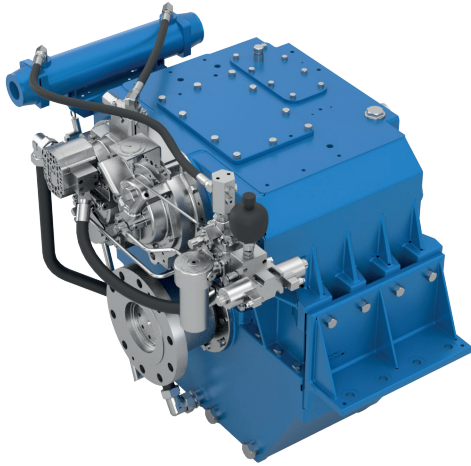

X52			
Power/RPM kW/RPM (hp/RPM)	Maximum rated input kW (hp)	Ratio	Maximum input RPM
0,611 (0,819)	1283 (1721)	3,964*	2100
		4,345*	
		4,962	
		5,458*	
		5,955	
Dry Weight kg(lb)	2000 (4410)		
SAE bell	#0		
Type	Vertical offset		
Kinematics	Reversible, Engine Wise and Counter Engine Wise		

\* Non standard ratio

## Sample Powers (kw/hp)

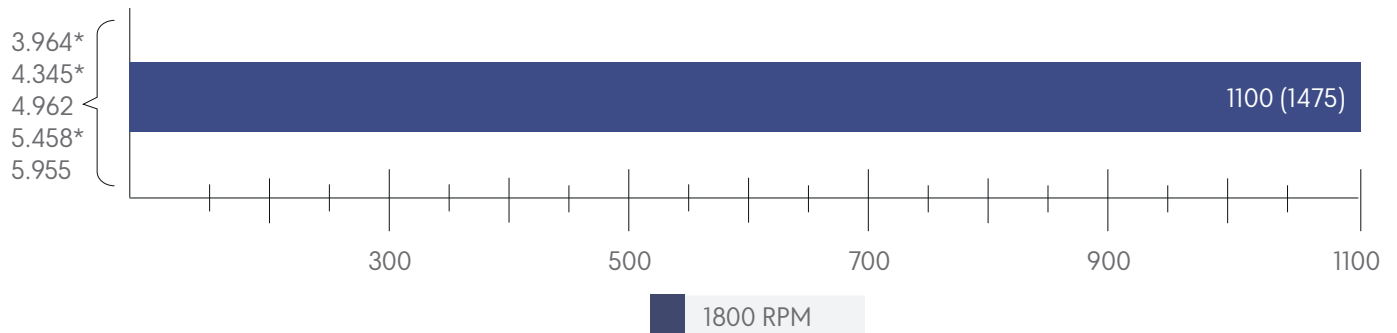

## Description

Robust design and easy onboard maintenance. Robust design also withstands continuous duty in workboat, dredger applications

Fully works tested, reliable and simple to install

Reverse reduction marine transmission with hydraulically actuated multi-disc clutches

Case hardened and precisely ground gear teeth for long life and smooth running

Robust cast iron casing for direct or remote mounting

Emergency "get home" capability

Suitable for twin installation with 100% rated power in ahead and astern condition

## Standard Equipment

Oil cooler complete with fittings and flexible hoses

Lube oil pump

Flanged coupling

Propeller shaft flange and coupling bolt set

Classification by all major Classification Societies on request

Elastic coupling with fail safe device SAE18"

Rigid mounting brackets

Electric clutch control

Set Control Monitoring:  
 Manometer and Thermometer gauges  
 Clutch oil pressure sensor monitored by the control system  
 Low clutch pressure alarm switch monitored by the engine BMS

## Options

Live PTO Type: 0 Ratio:0,791/1 /flange SAE B

Clutchable PTO Type: 1 for the one output /Electrical valve control 24V / Ratio: 0.600/1 - 0.733/1 - 0.867/1

Clutchable PTO Type: 2 for two outputs / Electrical valve control 24V / Ratio: 0.603/1 - 0.733/1 - 0.894/1

Hydraulic pump adaptation flange and coupling, not machined for type 182 (to be machined by the customer)

## Dimensions and dry weight (mm/kg)

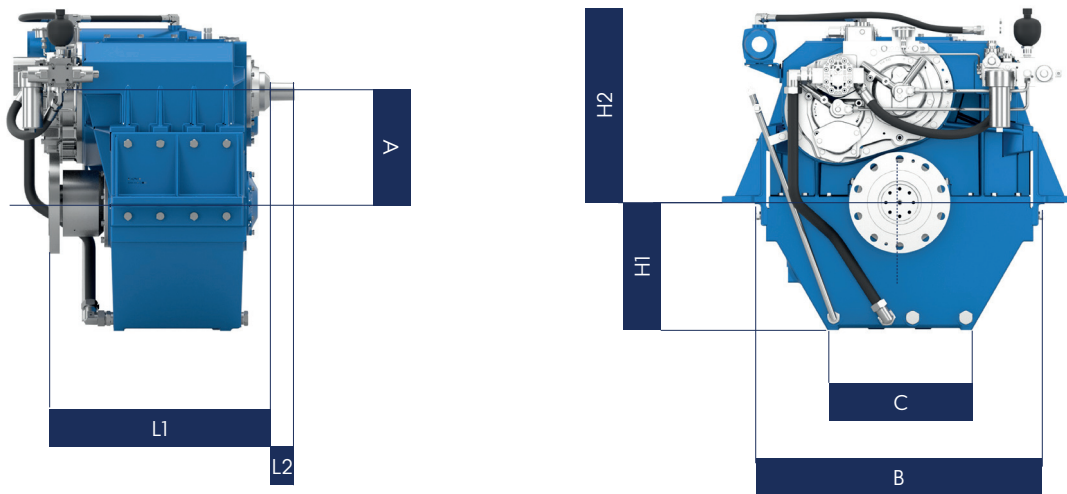

Model	Bell housing	A	B	C	H1	H2	H3	L1	L2	L3	Dry Weight kg(lb)
X52	#0	431	1116	550	492	742	0	855	90	1020	2000 (4410)

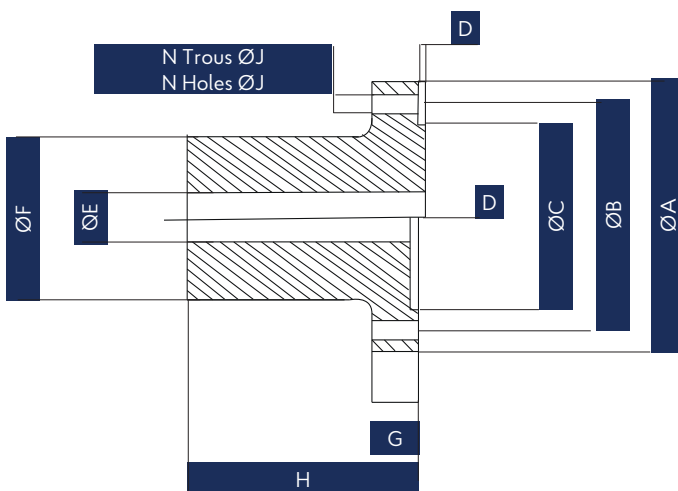

Type	ØA	ØB +0.15 /-0.15	ØC	D	ØE	ØF	G	H	J	N	Ømaxi forage Ømaxi drilling	CENTRAGE CENTERING
X52	390	336	250	6	75	260	55	320	31	10	160	Female

